

www.valleyrental.com



1401 Morganton Blvd.
Lenoir, N.C.
828-758-7400



Event and Equipment Solution Source

Business Hours

Monday	7:30 AM - 5:00 PM	Thursday	8:00 - 5:00 PM
Tuesday	8:00 AM - 5:00 PM	Friday	8:00 - 5:00 PM
Wednesday	8:00 AM - 5:00 PM	Saturday	8:00 - 1:00 PM
	Sunday - Closed		



Policies And Procedures

Reserving Equipment

Early planning ensures product availability. A 25% deposit is required to reserve equipment. A deposit is not a payment toward your rental fees. The deposit is security in case of cancellation, loss damage or late returns. Payment is expected in full 14 days prior to rental date.

Cancellation Charge

When a reservation is confirmed, all items are taken out of inventory and held for our clients event and as such are no longer available for rent on that date. Therefore a 25% cancellation charge will be imposed if the order is cancelled after reservation is made up until 14 days before rental date. At that time 100% cancellation charge will be enforced.

Delivery and Pick Up Service

Delivery and Pick Up service is available for all rentals. Prices are calculated based on location and dock to dock service. Additional charges apply to stairs, elevators and excessive distance for loading and unloading trucks. All items are to be delivered and picked up at a designated location. Standard delivery charge applies to our normal business hours. Additional charges will be applied for after hour requests. Clients may request a morning or an afternoon delivery or pick up. We try to accommodate all requests. Events that require exact time or extra time are subject to additional charges. The client should be available to count all items upon delivery and pick up. Otherwise the count will be considered accurate.

Set Up and Take Down of Rented Items

Rental items that require assembly such as tents, dance floor and staging usually include set up in the rental rate. Additional charges can apply to particularly difficult or unusual set ups that require extra time and/or labor. Set up and take down service is available for such items as tables and chairs for an additional fee. This service should be arranged in advance so that we can schedule labor and accurately quote a charge for this service.

Site Preparation

You should be certain that your site is ready for delivery and set up of rented equipment. Grass should be mowed in advance and vehicles should be moved from site. Valley Rentals offers free site evaluation. Please call in advance to make an appointment for one of our staff to meet with you and advise you of your options. The client is responsible for advising Valley Rentals of all underground utilities (i.e. gas lines, phone lines, irrigation systems, septic systems, etc.). Some equipment such as canopies must be staked down. All underground lines must be marked before installation can begin. The client assumes all responsibility for damage to underground utilities and systems. Call **811** prior to set up date. This is a free service. Someone will come out, locate, and mark all underground utilities for you. They require a minimum of 48 hour notice.

Computer Assisted Drawings

Cad drawings can be a valuable tool when planning an event. They take the guess work out of deciding on a floor plan. These drawings can be as simple as seeing how many tables and chairs will fit comfortably in a given area and increasing in complexity to the point of being able to take a virtual walk-thru of your event before the first table has been set up. Cost is determined by the complexity of the drawing and the amount of time required to produce them.

Returning Equipment

Dishes, flatware and serving pieces should be rinsed free of food and returned in the racks that you received them in. Linens should be shaken free of food and debris and should be allowed to dry before repacking. They can be returned on the hanger provided or in a box. **Do not place in plastic bags.** Damp linen will mildew quickly. Customers will be charged replacement cost on linen damage by but not limited to mildew, grease, burns and candle wax.

Customer Responsibility

The customer is responsible for equipment from the time of rental to the time of return. Equipment must be secure at all times and protected from the weather. When the equipment is delivered the customer assumes responsibility from the time of delivery until the time of pick up. Customer will be charged for repair or replacement cost of equipment that is damaged, lost or stolen while it is out on rental.

Customer understands that tents are temporary structures designed to provide limited protection from weather conditions. However there are situations, especially those involving strong wind and lightning, in which tents will not provide protection and may even be damaged or blown over.

Evacuation of tents to avoid possible injury is recommended when severe weather threatens. People must evacuate (and not seek shelter in) tents during such conditions. Client understands that it is customers responsibility to be aware of changing weather conditions and to exercise their best judgment with regard to the evacuation of tents.

Table of Contents

Equipment	Page
Air Conditioning	11
Audio Visual	4
Cake Displays	4
Candelabra.....	5
Candelabra Accessories	6
Canopies	7, 22, 23
Chairs.....	8
Chair Covers	8, 11
China.....	8
Coffee Urns	8
Colonnade Accessories.....	9
Concession Equipment	20
Concession Supplies.....	20
Coolers.....	8
Corinthian Columns.....	9
Costumes	9
Dance Floor.....	10
Flatware	10
Floral	4, 10
Fountains	10
Games.....	16, 17
Glassware	11
Heating.....	11
Helium	10
Inflatables.....	18, 19
Lattice Wedding Accessories	11
Lighting.....	11
Linen	12
Party Sales Items	24
Pipe And Drape	13
Policies And Procedures	2
Punch Bowls.....	13
Serving Items	13
Skirting	11
Staging.....	10
Tables	14
Wicker Wedding Accessories	14

Audio Visual

Audio Visual Cart.....	30.00
Bubble Machine.....	25.00
<i>Bubble Fluid sold Separately</i>	
Bullhorn.....	20.00
Carousel Projector.....	15.00
Coin Detector.....	16.00
DLP Projector.....	75.00
Easel; Aluminum Folding.....	12.00
Easel; Folding Presentation.....	20.00
Fog Dispenser.....	35.00
<i>Fog Fluid Sold Separately</i>	
Karaoke Machine.....	50.00
Lectern with Stand.....	50.00
Lectern w/Stand and Remote Mic.....	60.00
Light Carts 1000 Watts.....	30.00
Lighting, LED Colorado.....	40.00
Lighting Strands 48'.....	30.00
Microphone Wireless Receiver.....	40.00
*Microphones, Wireless Handheld.....	5.00
*Microphones, Wireless Headset/Lavalier.....	10.00
Mirror Ball w/Pin Light.....	35.00
Overhead Projector.....	15.00
Party Lights Double Derby.....	35.00
Party Lights, Elan LED.....	40.00
Party Lights; Orb LED.....	40.00
Presentation Device, Wireless, Laser....	20.00
Screen, Rollup 6'.....	15.00
Sky Cannon, Promotional Spotlight.....	125.00
Snow Machine.....	100.00
<i>Snow fluid Sold Separately</i>	
Sound System, 150 Watt w/CD Player ..	100.00
Sound System, 250 Watt.....	125.00
Spot Light, LED Follow Spot w/Tripod ...	65.00
Stanchions; w/10' Chain White.....	6.00
Stanchions; Chrome Retractable Belt....	12.00
Strobe Light.....	10.00

* Requires wireless receiver



Cake Displays

Cake Fountain.....	20.00
Cake Knife and Server.....	10.00
Cake Plateau; Silver 14" Square.....	20.00
Cake Plateau; Silver 16" Round.....	30.00
Cake Plateau; Silver 19" Round.....	30.00
Cake Plateau; Silver 17" Square.....	30.00
Cake Stands; Acrylic 3 Tier.....	35.00
8", 10", 12" Diameter	
Cake Stands; Chrome.....	25.00
6", 10", 14" Diameter	
Cake Stand; White 22" x 8".....	18.00
Cake Stand; Vintage White 10".....	10.00
Cake Stand; Vintage White 16".....	15.00
Cake Stand; Vintage White 22".....	18.00
Cake Stand; White Wrought Iron.....	30.00
8", 12", 16" Diameter	
Satellites (2) 8" Diameter	

C A N D E L A B R A

	Brass	Chrome	Black	White
Aisle Marker– Clip On	10.00	10.00		
Aisle Marker– Free Standing	10.00	10.00		
Aisle Marker– Trinity	15.00			
Angel Wings– 10 Candles- Teardrop		35.00		
Double Rings– 18 Candles	40.00			
Fan Arc– 15 Candles	35.00	35.00		
Fan Arc– 10 Candles– Teardrop		35.00		
Heart– Single 17 Candles	35.00			
Heart– Double 18 Candles	40.00			
Slope– 7 Candles	20.00	25.00	35.00	25.00
Spiral– 15 Candles	35.00	35.00		
Spiral– 10 Candles– Teardrop		40.00		
Tree– 5 Candles– Pillar (not included)			35.00	
Tree– 9 Candles	25.00	30.00		30.00
Tree– 9 Candles– Teardrop		40.00		
Tree– 13 Candles	30.00			
Tree– 29 Candles	50.00			
Unity– 3 Candles	15.00	20.00	20.00	20.00
Unity– 3 Candles– Double Rings	25.00			

Candles are included with candelabra rental except where noted. Votive candles can be substituted for taper candles



C
A
N
D
E
L
A
B
R
A

	Brass	Chrome	Wrought Iron	White
Arbor- Grecian			145.00	
Arch	30.00	30.00	60.00	35.00
Arch Extension 18"	7.00	7.00		
Arch Flower Stands (Pair)	15.00	15.00		
Arch- Heart Shaped	40.00	40.00		
Arch- Limbs and Branch			40.00	
Easel	15.00	15.00	15.00	
Fan Arc Attachment- 10 candles	20.00			
Flower Bowls	2.00			
Flower Stands- Adjustable	8.00	8.00		
Flower Stands			8.00	
Kneeling Benches	30.00	35.00		35.00
Lighter/Snuffer	8.00	10.00		
Lighter- Unity	6.00	6.00		
Registry Stand	20.00	25.00		25.00
Tree- Weeping Willow			50.00	
Unity- Tabletop	15.00			
Vestal Lamps	6.00			

ACCESSORIES

Candelabra- Tabletop

- Brass- 3 Light- Teardrop 28" H..... 5.00
 - Brass- 5 Light 15.00
 - Brass- 9 Light 25.00
 - Chrome- 3 Light- Teardrop 28" H 5.00
 - Chrome- 1 Light Scroll- Teardrop..... 5.00
 - Chrome- 3 Light Scroll- Teardrop..... 6.00
 - Lantern- Black or White 5.00
 - Silver- Candle Stick 4 1/2" or 7 1/2" 6.00
 - Silver- 3 Light 10.00
 - Silver- 5 Light..... 15.00
 - Silver- 5 Light Large..... 25.00
 - Wrought Iron- 5 Light- Black 25.00
- Pillar Candles Not Included*



** www.valleyrental.com ** Lenoir 758-7400

Canopies

Canopies; Frame

Canopy; Accessories

Please Call For Competitive Pricing

Sizes Available

10 x 10	30 x 30
10 x 20	30 x 45
10 x 30	30 x 60
10 x 40	30 x 75
15 x 15	30 x 90
20 x 20	40 x 40
20 x 30	40 x 60
20 x 30 High Peak	40 x 80
20 x 40	40 x 100
20 x 40 High Peak	40 x 120

Air Conditioning; 1 Ton 120V 15 AMP	120.00
Fans; Pole	15.00
Fans; Floor	32.00
Fans; Misting 13"	25.00
Fans; Misting 30"	60.00
French Door; Double.....	225.00
Gutter (Per Foot).....	1.00
Heater; 90M BTU Kerosene, Indirect	80.00
Heater; 90M BTU LP Gas	80.00
<i>Kerosene and LP Gas Sold Separately</i>	
Leg Skirts.....	15.00
Liner (Per Sq. Foot)50
Lighting; Alfresco Arm 20".....	15.00
Lighting; Crystal Chandelier.....	125.00
Lighting Strands 48'	30.00
Lighting; Par.....	15.00
Lighting Post; White Ornate	40.00
Sidewall 8' w/Windows.....	1.75
Sidewall 8' Keder w/ Windows	2.00

Canopies; Party

- 20 x 20
- 20 x 30
- 30 x 60

Party Canopy style tents are only the tent top, it has no sidewalls. It is very economical if you are looking for a little shade, rain cover or ambiance! The canopy must be staked into the ground and requires 4-5 additional feet on all four sides for staking.

Frame tents are much stronger and durable. Frame tents can sustain higher amounts of wind. A frame tent uses a system of aluminum poles (much like a truss system in a house) to form a free standing structure that the tent fabric is secured to. The frame eliminates the need for interior center poles leaving more room under the tent. The frame is typically built on the ground, skinned with fabric and raised into place. The freestanding metal structure supports itself and does not rely on the tension of guy ropes to keep it standing. Frame tents must be anchored, preferably using 3' stakes into solid ground.

Marquee tents are great to enhance an entrance, to cover walkway, or can be used in smaller places, like decks, patios or even to cover a port-a-toilet!

Pop-up tents are 10' x 10'. Simple set up allows for customer installation.

Canopy prices include set up and take down within a 15 mile radius of our store. Additional charges may apply for extended travel and/or difficult set ups.

For tent sizing Chart And additional Information Please See Pages 22 ,23

Chairs

Chair; White, Folding	1.10
Chair White Wedding, Folding	1.50
Chair; White Resin, Folding, Padded Seat	3.00
Chair; Fruitwood, Neutral Padded Seat..	3.00

Chair Covers

Chair Cover; Folding.....	2.50
<i>Black, Ivory or White</i>	
Chair Cover; Banquet	2.50
<i>Black, Ivory or White</i>	
Chair Sashes; Poly	1.00
Chair Sashes; Organza	1.50

Sashes are Available in a Variety of Colors



White Resin Chair



Fruitwood Chair

China *Ivory w/Gold Band*

Bouillon Cup and Saucer50
Bread and Butter Plate 6"40
Coffee Cup and Saucer50
Cream and Sugar Set.....	2.00
Dinner Plate 10"45
Salad or Dessert Plate 7"40
Soup Bowl45



China *White Whirl*

Bread and Butter Plate 6"40
Bowl 10 oz.....	.40
Coffee Cup and Saucer50
Dinner Plate 10"45
Salad or Dessert Plate 7"40



White Wedding Chair

Coffee Urns

36 Cup Ornate.....	20.00
55 Cup Standard	15.00
55 Cup Ornate.....	20.00
90 Cup Standard	20.00

Coolers And Dispensers

Beer Keg Cooler w/Wheels.....	20.00
Beer Keg Tap	10.00
Beverage Dispenser; 5 Gal. Hot/Cold	15.00
Beverage Dispenser; 2.5 Gal. Glass.....	15.00
Beverage Dispenser; 2.5 Gal Mason Jar	12.00
Carafe; 8 Cup	2.00
Cooler; Acrylic 2 Gal.	20.00
Cooler on Wheels 24" x 51"	35.00
Cooler on Wheels 30" x 16"	20.00
Gott Cooler; 10 Gal.....	10.00

Corinthian Columns and Accessories



Folding Chair Cover w/ Sash

Balustrade 2 Post; curved.....	20.00
Balustrade 3 Post; 36"H x 48"L	25.00
Colonnade Arch	25.00
Colonnade Curved Crown 68" L.....	25.00
Colonnade Straight Crown 68" L.....	25.00
Column; 32" H	10.00
Column; 40" H	12.00
Column; 72" H	20.00
Column; 96" H	30.00
Column Light Base	8.00
Column; Square 36" H	15.00
Flower Urn; 19" H	10.00
Garden Bench; 17"H x 52"L	25.00
Water Fountain; Floor	60.00



Costumes

We carry Character and Holiday Costumes.

Dance Floor and Staging

Dance Floor; Per Sq. ft. Installed	1.10
Dance Floor; Simulated Wood, Per Sq ft.	2.00
Staging; 4' x 4' Section	30.00
Staging; Curved Front.....	25.00
Stage; 45 Degree Angle	25.00
Staging; Two Step Stair Set.....	30.00
Staging; Guardrail 4' Section	10.00

Tips on Choosing your Dance Floor

- 2 to 4 sq. ft. per person is required
- Usually no more than 50% of guests will dance at one time
- Dance Floors can be set up indoors or out.
- Sub-flooring is required for grass set-up

Dance Floor Capacity Chart		
Total # Of Guests	Total # of Dancers	Size of Dance Floor
60	20	9ft x 9ft
100	30	12ft x 12ft
150	50	15ft x 15ft
200	70	18ft x 18ft
275	90	20ft x 20ft
400	140	25ft x 25ft
600	200	30ft x 30ft
1000	350	40ft x 40ft
1500	550	50ft x 50ft

Flatware

Bouillon Spoon35
Dinner fork.....	.35
Knife.....	.40
Salad Fork.....	.35
Soup Spoon35
Steak Knife.....	.35

Flatware, Serving

Berry Spoon	2.00
Gravy Ladle	2.00
Meat Fork.....	2.00
Serving Spoon.....	2.00

Fountains

Anodized 3 Gal.....	30.00
Anodized 5 Gal.....	38.00
Chocolate Fountain	<i>Call For Pricing</i>
Stainless; Starlight 4 Tier, 5 Gal.	65.00
Stainless; Gold Trim, 5 Gal.....	50.00
Stainless; Silver Trim, 5 Gal.....	50.00
Water Fountain; Floor.....	60.00

Floral & Decorative Items

Balloon Inflator; Cool Air	20.00
Barrel: Oak	25.00
Ferns	10.00
Ficus Tree, 3'.....	6.00
Ficus Tree; 6'.....	12.00
Garland	4.00
Helium.....	<i>Call For Pricing</i>
Palm Tree; Areca.....	25.00
Palm Tree; Coconut 9'	35.00
Palm Tree; Canvas 2' White or Green ...	8.00
Palm Tree; Canvas 3' White or Green ...	10.00
Palm Tree; Canvas 5' White or Green ...	12.00
Pedestal; Bamboo 12" H.....	4.00
Pedestal; Bamboo 18" H.....	5.00
Pedestal; Bamboo 24" H.....	6.00
Pedestal; Bamboo 30" H.....	7.00
Swags	3.50
Topiary	20.00
Vase; Brandy Snifter 60oz.	3.00
Vase; "Eiffel" 28" H	6.00
Vase; "Eiffel" 20" H	3.00
Vase; 4" x 4" x 4"	3.00
Vase; 6" x 6" x 6"	5.00
Vase; 10" x 4" x 4"	4.00
Wisteria	25.00

Glassware

Bar Glass 11 oz.....	.40
Champagne Flute; 6 oz.....	.40
Champagne Traditional 4 oz.....	.40
Cream and Sugar Set.....	1.75
Glass Bowl; 8".....	.40
Glass Plate; 6".....	.35
Glass Plate; 8".....	.35
Glass Plate; 9".....	.40
Irish Coffee Mug; 10 oz.....	.50
Ivey Bowl.....	.75
Margarita Glass 12 oz.....	.40
Martini Glass; 5 oz.....	.40
Pilsner Glass; 10 oz.....	.40
Punch Cup; 6 oz.....	.35
Salt and Pepper Set (small).....	.50
Tea or Water Glass; 12 oz.....	.35
Tea or Water Goblet; 16 oz.....	.40
Water Pitcher.....	1.50
Wine Glass; 8 oz.....	.40
Wine Glass; 13 oz. Red Wine.....	.40

Lattice Accessories

Arch; 90" W x 14" D x 95" W.....	40.00
Flower Stand; 36" H.....	10.00
Flower Stand; 42" H.....	12.00
French Door Backdrop; 40" W x 90" H ...	50.00
Gazebo; 80" W x 80" D x 80" H.....	150.00
Privacy Panel; 4 Section 80" W x 72" H..	20.00
Registry Stand.....	20.00
Wishing Well; 24" H.....	12.00



Heating and Air Conditioning

Air Conditioner; 1 Ton 120V.....	120.00
Evaporative Cooling Unit.....	75.00
Evaporative Cooling Unit.....	125.00
Fan; 36" Floor.....	32.00
Fan; Misting 13".....	25.00
Fan; Misting 30".....	60.00
Heater; 90M BTU Kero., Indirect (Tent)..	80.00
Heater; 90M BTU LP Gas (Tent).....	80.00
Heater; Bistro Table 16M BTU.....	40.00
Heater; Patio 40M BTU.....	40.00

Kerosene and LP Gas Sold Separately



Lighting

Garden Lights (Black Iron).....	10.00
Light Carts; 1000 Watt.....	30.00
Lighting; Par.....	15.00
Lighting; LED Colorado.....	40.00
Light Strands.....	
Light Post; Ornate.....	40.00

Linen

Banquet

Banquet; 54" x 120" White.....	9.00
Banquet; 54" x 120" Colors.....	10.00
Banquet; 88" x 130" White.....	16.00
Banquet; 88" x 130" Colors.....	17.00
Banquet; 88" x 154" White.....	18.00
Banquet; 88" x 154" Colors.....	19.00

Round

Round; 90" White.....	9.00
Round; 90" Colors.....	10.00
Round; 96" Colors.....	10.00
Round; 96" White.....	9.00
Round; 108" White.....	12.00
Round; 108" Colors.....	13.00
Round; 120" White.....	15.00
Round; 120" Colors.....	16.00
Round; 132" White.....	18.00
Round; 132" Colors.....	19.00

Chair Covers

Chair Cover; Folding.....	2.50
<i>Black, Ivory or White</i>	
Chair Cover; Banquet.....	2.50
<i>Black, Ivory or White</i>	
Chair Sashes; Poly.....	1.00
Chair Sashes; Organza.....	1.50

Sashes are Available in a Variety of Colors

Serpentine And Squares

Serpentine; White.....	10.00
Square; 54" x 54" White.....	5.00
Square; 60" x 60" White.....	6.00
Square; 60" x 60" Colors.....	7.00
Square; 70" x 70" White.....	7.00
Square; 70" x 70" Colors.....	8.00
Square; 90" x 90" White.....	9.00
Square; 90" x 90" Colors.....	10.00

Napkins

Napkins; 20" x 20".....	.60
-------------------------	-----

We have a large selection of colors in our inventory and we are constantly adding more. Please talk to one of our representatives and let them help you with color and size selection

Table Size	Dining Length	Floor Length
36" Round	54" x 54"	96" Round
48" Round	60" x 60"	108" Round
60" Round	90" Round	120" Round
72" Round	96" Round	132" Round
6' Banquet	54" x 120"	88" x 130"
8' Banquet	54" x 120"	88" x 154"

Skirting

Skirting; White or Ivory (per ft.).....	1.25
Skirting; Black (per ft.).....	1.25
Skirting; Stage, Black (per ft.).....	2.00



The above prices are for poly/cotton blends and polyester. Specialty fabrics and special orders may be slightly more.

Pipe and Drape

Pipe & Drape Base; Small	1.00
Pipe & Drape Base; Large	1.00
Pipe & Drape Panel: 8' x 4'	3.00
Pipe & Drape Panel; 3' x 4'	2.00
Pipe & Drape Telescopic Rod	3.00
<i>Stops at 6', 8', 10'</i>	
Pipe & Drape Uprights; 3'	2.00
Pipe & Drape Uprights; 8'	3.00
Stanchions w/10' Chain White	6.00
Stanchions Chrome Retractable Belt	12.00

Please call and ask one of our representatives to assist you in determining your needs

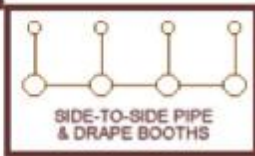
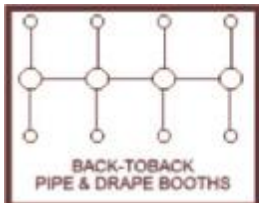

Punch Bowls

Glass; Assorted	8.00
Glass; Daisy & Button	12.00
Silver w/ Tray and Ladle	25.00
Stainless; 3 Gallon	15.00
Stainless; 5 Gallon	18.00

Serving Items

Bread Baskets30
Carving Board w/Heat Lamp	40.00
Insulated Carrier (for chafing pans)	35.00
Proofing Oven	90.00
Salad Cambro	10.00
Tray; 3 Tier Granite	30.00
Tray; 3 Tier Mirror	30.00
Tray; 3 Tier w/ Acrylic Bowls	15.00
Tray; 3 Tier Vine, w/ Bowls	15.00
Tray; Glass 11" x 16"	6.00
Tray; Glass 12" x 24"	8.00
Tray; Glass 22" x 22"	8.00
Tray; Square Pewter w/Stand	18.00
Waiter Tray 22" x 26"	5.00
Waiter Tray Stand	5.00

Serving Items; Chafers

Round

Chafers; 3 qt. Silver	25.00
Chafers; 4 qt. Stainless	15.00
Chafers; 6 qt. Stainless	18.00
Chafers; Electric Element	20.00

Rectangular

Chafers; 8 qt. Stainless	12.00
Chafers; 8 qt. Stainless, Ormate	15.00
Chafers; 8 qt. Stainless, Roll Top	20.00
Chafers; 8 qt. w/ Soup Tureen	20.00
Chafers Electric Element	20.00

Serving Items; Silver

Champagne Bucket	10.00
Ice Tongs	2.00
Nut Dish	4.00
Tray; Round 12"	12.00
Tray; Round 14"	12.00
Tray; Round 16"	14.00
Tray; Round 18"	16.00

Serving Items; Stainless

Chip & Dip	15.00
Party Tub; 7 Gallon	10.00
Pastry Server; 12"	2.00
Pastry Tongs; 8"	2.00
Spoons	2.00
Tongs	2.00
Tray; 3 Tier large	20.00
Tray; Round 10"	6.00
Tray; Round 15"	7.00
Tray; Round 20"	9.00
Tray; Round 25"	12.00

Tables

Banquet 6' x 30"	7.00
Banquet 8' x 30"	8.00
Bar 6' w/Table and Linen	40.00
Barrels w/ 72" Oak Tabletop	70.00
Card Table 37" x 37"	5.00
Chill and Fill 6'	25.00
Chill and Fill Depth Extension	10.00
Chill and Fill Insert	5.00
Corner Table; 1/4 Round	10.00
Poker; Round 52" Diameter	30.00
Poker, Oval 82"	30.00
Round 36" Diameter	7.00
Round 48" Diameter	7.00
Round 60" Diameter	8.00
Round 72" Diameter	12.00
Round 30" Diameter Café 42" H	10.00
Seminar 8' x 18"	10.00
Seminar 5' x 18"	8.00
Serpentine	10.00
Serpentine Table w/ Riser	25.00
Serpentine Table w/Riser & Linen.....	40.00
Square 60"	8.00

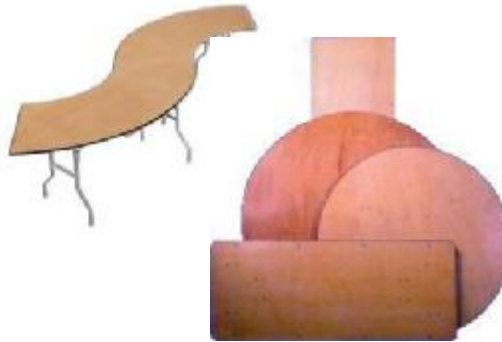

Wicker (White)

Arch; Standard	35.00
Arch; Heart or Wide	40.00
Flower Stand; 30" H.....	9.00
Flower Stand; 42" H.....	10.00
Flower Stand; 72" H.....	15.00
Gazebo.....	125.00
Registry Stand.....	15.00
Wishing Birdcage.....	15.00
Wishing Heart on Post.....	20.00
Wishing Heart; Tabletop	15.00



SUGGESTED SKIRTING SIZES			
HRZ. LENGTH	TABLE SIZES		
13'	48"	6' x 30"	8' x 30"
17' 6"	60" 66"	6' x 30"	(2) 6' x 30"
21' 6"	72"	8' x 30"	(2) 8' x 30"

Canopies

Concessions

Games

Inflatables



Games



Tic Tac Toe



Toss And Knock



Plinko



Can Smash



Grab A Duck

Alien Autopsy (operation)	40.00
All Aboard Noah's Arc	35.00
Baseball Pitch	35.00
Bingo (Includes 100 Slide Cards)	35.00
Bocci Ball	25.00
Bolder Roller	40.00
Casino; Blackjack Layout	10.00
Casino; Craps & Dice Layout	10.00
Casino; Roulette Wheel w/Layout	30.00
Cow Milking	35.00
Driving Range (Auto).....	35.00
Duck Pond	40.00
Dunking Booth	150.00
Golf Birdie Putt.....	35.00
Golf Challenge	35.00
Quarter Pitch.....	35.00
Hoop It Up.....	35.00
Horse Shoe Set.....	15.00
Pig Race	60.00
Pirate Hoop Toss	20.00
Plinko	35.00
Prize Wheel; 24 Spaces.....	35.00
Raffle Cage.....	10.00
Ring Toss.....	35.00
Sno Ball	35.00
Spin Art.....	35.00
Striker Bell; Giraffe	40.00
Striker Bell; 6'	40.00
Striker Bell; 14' Trailer Mounted	125.00
Tic-Tac-Toe	35.00
Toss and Knock	35.00
Volleyball	25.00



Sno Ball



Ring Toss



Driving Range



Alien Autopsy



Hoop It Up



Duck Pond



Bingo



Pirate Hoop Toss



Golf Challenge



Prize Wheel
Cow Milking



Golf Birdie Putt



Spin Art



Hit The Green



Wave Runner



Dunking Booth



Baseball Pitch



All Aboard Noah's Arc



Striker Bell Giraffe



Striker Bell 6'



Striker Bell 14'



Pig Race



Disney Jump
15' x 15'



Buccaneer Combo
17' x 16' x 27'



Castle
13' x 13'

Bouncers

- Beagle Bounce..... 125.00
- Castle 13' x 13' 125.00
- Disney Jump 15' x 15' 150.00
- Fun House; 14' x 20' 175.00
- Pirates Of The Caribbean Jump 150.00
- Tiger Bounce 12' x 13' x 25' 125.00



Fan Man
20'



Dora Combo
18' x 19' x 15'

Combos

- Buccaneer 17' x 16' x 27' 275.00
- Dora 225.00
- Enchanted Forest..... 225.00
- Ninja 225.00
- Noah's Arc 225.00
- Obstacle Course 250.00
- Obstacle Course & Double Lane Slide ... 525.00

Slides

- Backyard 24' x 10' 125.00
- California Wave Slip and Slide 200.00
- Double Lane Slide 45' x 12' x 18' 300.00



Balloon on
Wheels



Tiger Bounce
12' x 13' x 25'

Games

- Circus Seals..... 125.00
- Mini All Stars..... 100.00

Advertising

- Balloon on Wheels 75.00
- Cash Vault 100.00
- Fan Man..... 75.00

***Double Slide and Obstacle Course can
be joined together for 78' of Fun !***



Double Slide
45' x 12' x 18'



Obstacle Course
33' x 11' x 12'



Slide , Backyard
24' x 10'



Cash Vault
5' x 5' x 9'



Fun House Large
14' x 20' x 12'



California Wave
33' x 10' x 7'



Ninja 5 in 1
18' x 19' x 15'



Noah's Arc Combo
18' x 19'



Mini All Stars
10' x 10' x 8'



Pirate Bounce
14' x 13' x 12'



Enchanted Forrest
18' x 22'



Circus Seals
13' x 11' x 9'



Beagle Bounce
14' x 13' x 28'

Concession Equipment

Cotton Candy Machine.....	50.00
Cotton Candy Cart	20.00
Grill; Charcoal 5' x 2'	40.00
Grill; 6' LP Gas; Towable	100.00
<i>Price Does Not Include LP Gas</i>	
Hot Dog Rotisserie.....	45.00
Hot Dog Steamer	30.00
Nacho Dispenser	40.00
Popcorn Popper	35.00
Popcorn Cart.....	20.00
Pucker Powder Machine w/ 3 Flavors	75.00
Pucker Powder Machine w / 6 Flavors ...	150.00
Slushie Machine; Double Bowl	125.00
Sno Cone Machine	40.00

Concession Supplies

Cotton Candy Bags (100).....	5.95
Cotton Candy Cones (25)	1.00
Cotton Candy Floss (1/2 gal.).....	7.25
Nacho Cheese 140 oz.....	17.95
Nacho Trays (50)	3.00
Popcorn Bags (100)	4.00
Popcorn Kit; Corn/Butter 6 oz (ea).	1.25
Popcorn Kit; Corn/Butter 6oz.(36)	39.95
Slushie Concentrate (1 to 4).....	8.50
Sno Cone Cups (200)	9.50
Sno Cone Syrup (gal.).....	9.95
Sno Cone Syrup (qt.	3.39

Product	Yield
Cotton Candy Floss (1/2 gal.)	64 Cones
Popcorn-Butter Pack	6- 1 oz. Bags
Slushie Concentrate (1 qt.)	2 1/2 gallon
Sno Cone Syrup (1 gal.)	120 Cones (1 oz. per cone)



Snow Cone Machine



Pucker Powder



Popcorn Popper



Cotton Candy Machine



Slushie Machine



Nacho Machine



Gas Grill



Hot Dog Rotisserie



Hot Dog Steamer



Charcoal Grill

Tent Sizing Chart

TENT SIZE	Total Square Feet	Maximum Ceremony 8 Sq. Ft.	Maximum Cocktails * 10 Sq. Ft.	Maximum Seating With 60" Rounds 12 Sq. Ft.	Maximum Seating With 8' Rectangles 10 Sq. Ft.
10 x 10	100	12	10	8	10
15 x 15	225	28	22	16	22
20 x 20	400	50	40	32	40
20 x 30	600	75	60	48	60
20 x 40	800	100	80	64	80
30 x 30	900	112	90	72	90
30 x 45	1350	154	120	104	120
30 x 60	1800	225	180	150	180
30 x 75	2250	280	215	184	225
30 x 90	2700	335	270	225	270
40 x 40	1600	200	160	128	160
40 x 60	2400	300	240	200	240
40 x 80	3200	400	320	256	320
40 x 100	4000	500	400	333	400
40 x 120	4800	600	480	400	480

*Cocktails includes seating for 1/3 of guests and space for Bars

Additional Space Allowances:

Dance Area: 2-4 sq.ft. per person, **Bar Area:** 10 sq.ft., **Band:** 100 sq.ft.

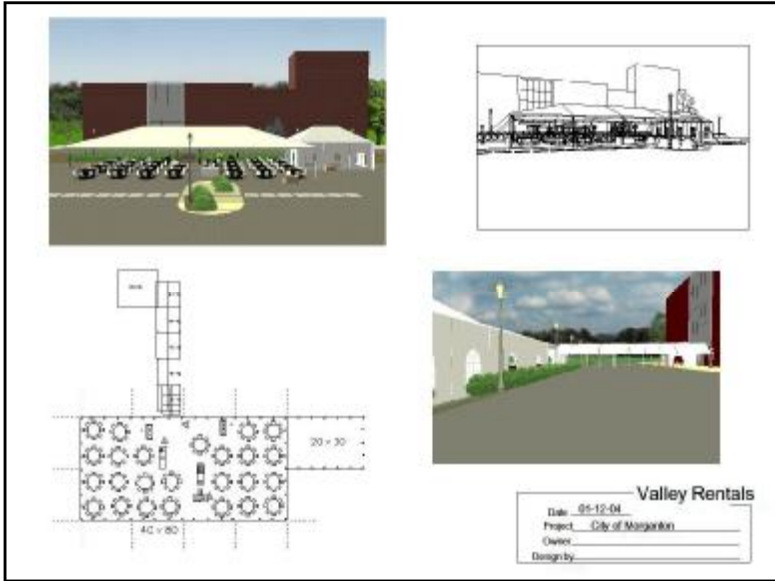

Computer Assisted Drawings



Tent Liner and Lighting



Party Sales Items

Plastic Cups & Flatware

Champagne 4 oz.....	25 pk	6.45
Champagne Flute 5 oz.....	10 pk	4.25
Flatware.....	100 pk.	5.95
Punch Cups 6 oz.....	20 pk	5.75
Tumblers 9 oz.....	25 pk	2.50
Tumblers 10 oz.....	25 pk	2.50
Tumblers 12 oz.....	25 pk	4.50
Wine Stemmed 5 oz.....	25 pk	6.45

Plastic Plates

Plate 6".....	20 pk	5.95
Plate 7 1/2".....	20 pk	6.95
Plate 9".....	20 pk	9.95
Plate 10".....	20 pk	11.95

Party Accessories

Aisle Runner 50'.....	15.95
Aisle Runner 100'.....	25.95
Globe Light; Organza 16".....	3.95
Sterno Fuel.....	1.50
Fog Fluid gal.....	39.95
Snow Fluid gal.....	35.95

Concession Supplies

Cotton Candy Bags.....	100 pk	5.95
Cotton Candy Cones.....	25 pk	1.00
Cotton Candy Floss.....	1/2 gal.	7.25
Nacho Cheese 140 oz.....		18.25
Nacho Trays.....	50 pk.	3.00
Popcorn Kit; Corn/Butter 6 oz.....		1.25
Popcorn kit; Corn/Butter 6 oz.....	36 cs	39.95
Popcorn Bags.....	100 pk	4.00
Slushie Concentrate (1 to 4).....		8.50
Sno Cone Cups.....	200 pk	9.50
Sno Cone Syrup.....	1 gal	9.95
Sno Cone Syrup.....	1 qt	3.39
Sno Cone Pumps.....		6.00

Paper Products

Cups 9 oz.....	25 pk	3.25
Napkins; Beverage.....	50 pk	1.95
Napkins; Luncheon.....	50 pk	2.95
Napkins; Dinner.....	50 pk	3.95
Placemats; 9" x 14".....	50 pk	3.50
Plates 7".....	25 pk	2.90
Plates 9".....	25 pk	3.75

Prices are for solid colors only. Prints run slightly higher.

Table Covers; Vinyl

Solid 54" x 108".....	2.25
Solid 82" Round.....	3.35
Solid Roll 40" x 100'.....	17.25
Solid Table Skirt 13' x 29".....	5.95
Print 82" Round.....	4.75
Print 54" x 108".....	3.45
Print Table Skirt 13' x 29".....	6.75

We offer a complete selection of Personalized Invitations, Social Announcements, Napkins and Accessories.

4/10/19